

How to upload Firmware update on RF11iQP

Open browser window (Firefox, Chrome, Safari etc) and type in IP address of RF11iQP. For example <http://192.168.2.128:8081>

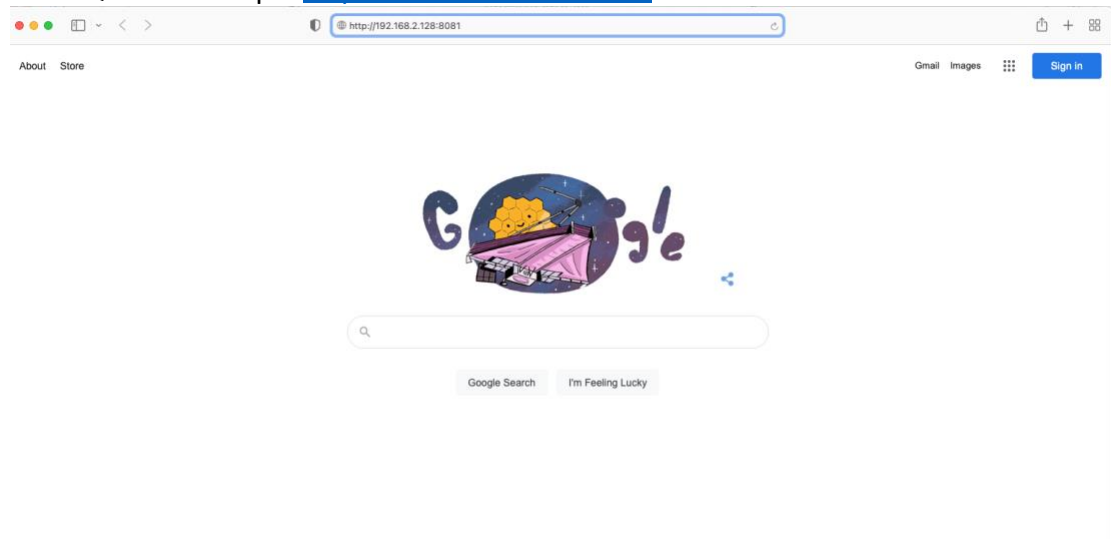

The RF11iQP login page will show...



User: admin Password: THORRF11 (default login credentials). If you have changed the Login credentials please type in your saved username and password.

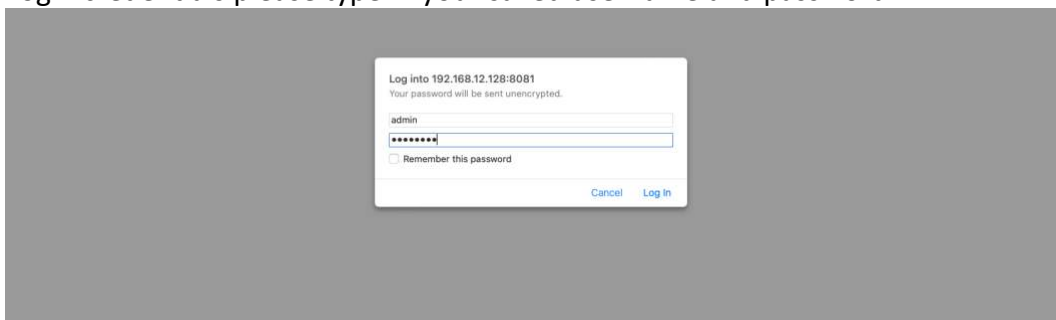

RF11iQP Homepage will be presented...

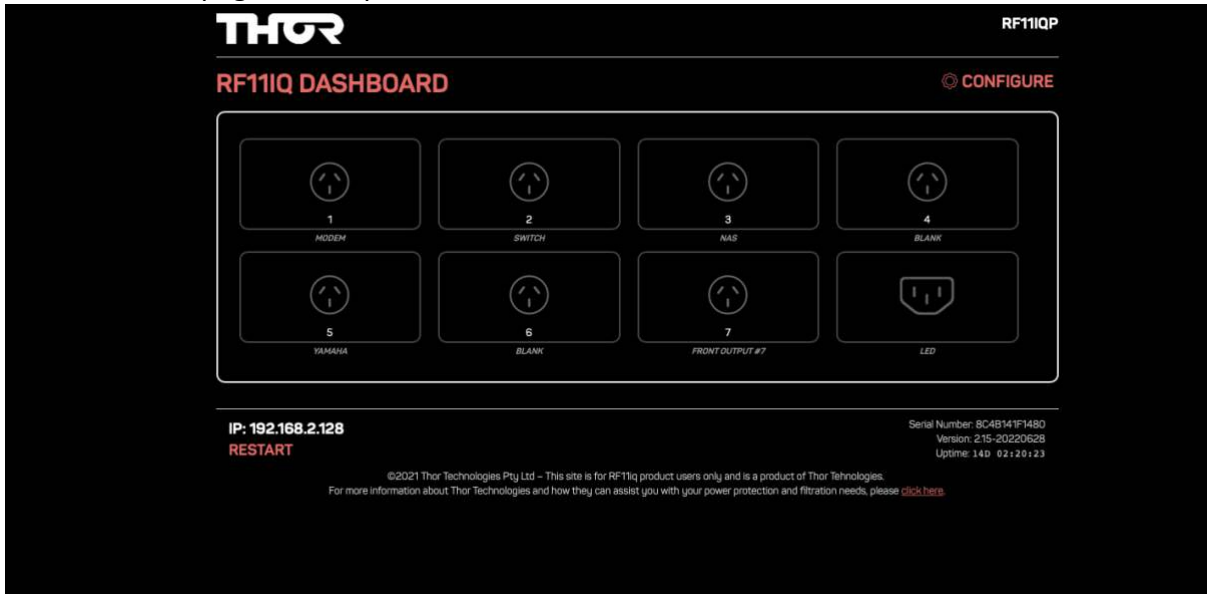

Note: Firmware version under Serial Number/MAC Address bottom R/H/S of screen

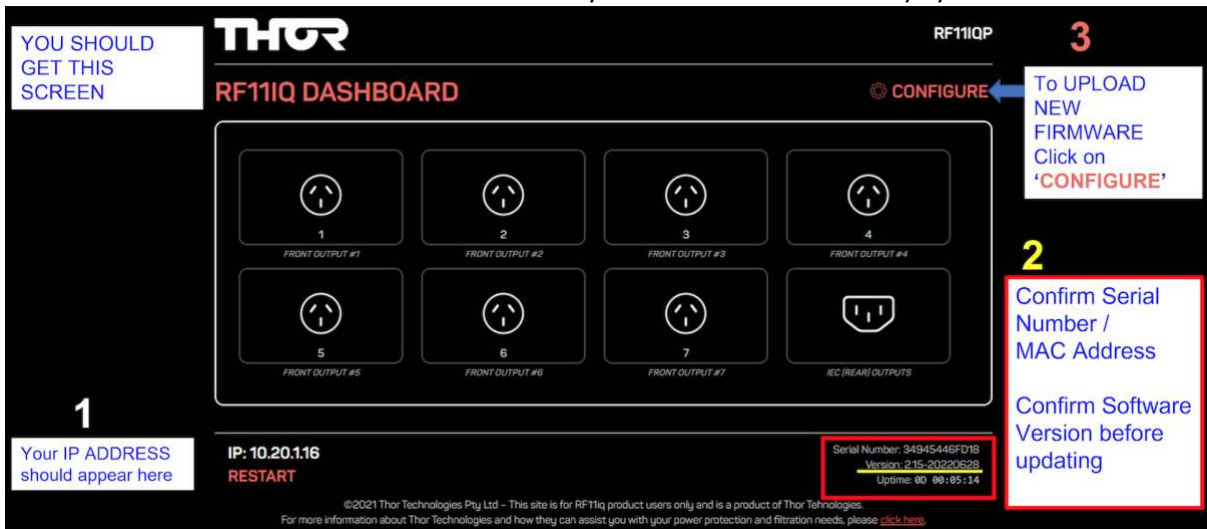

Select "CONFIGURE" to open configuration page

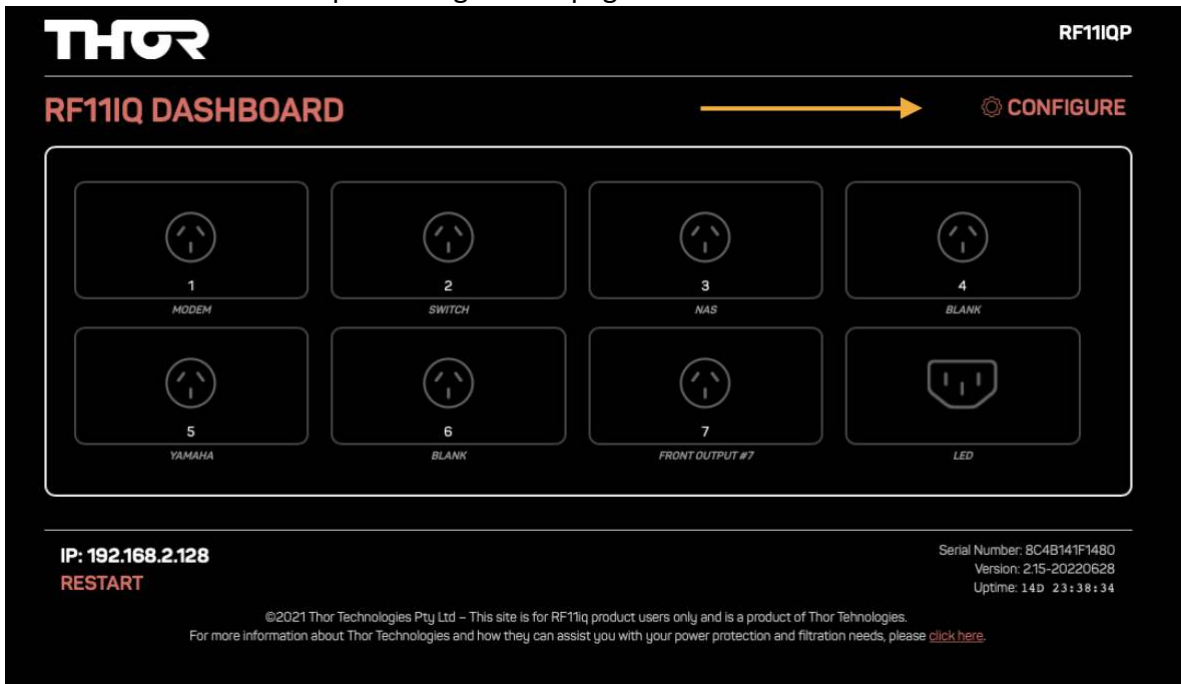

Find the "Firmware" section in Configuration page.

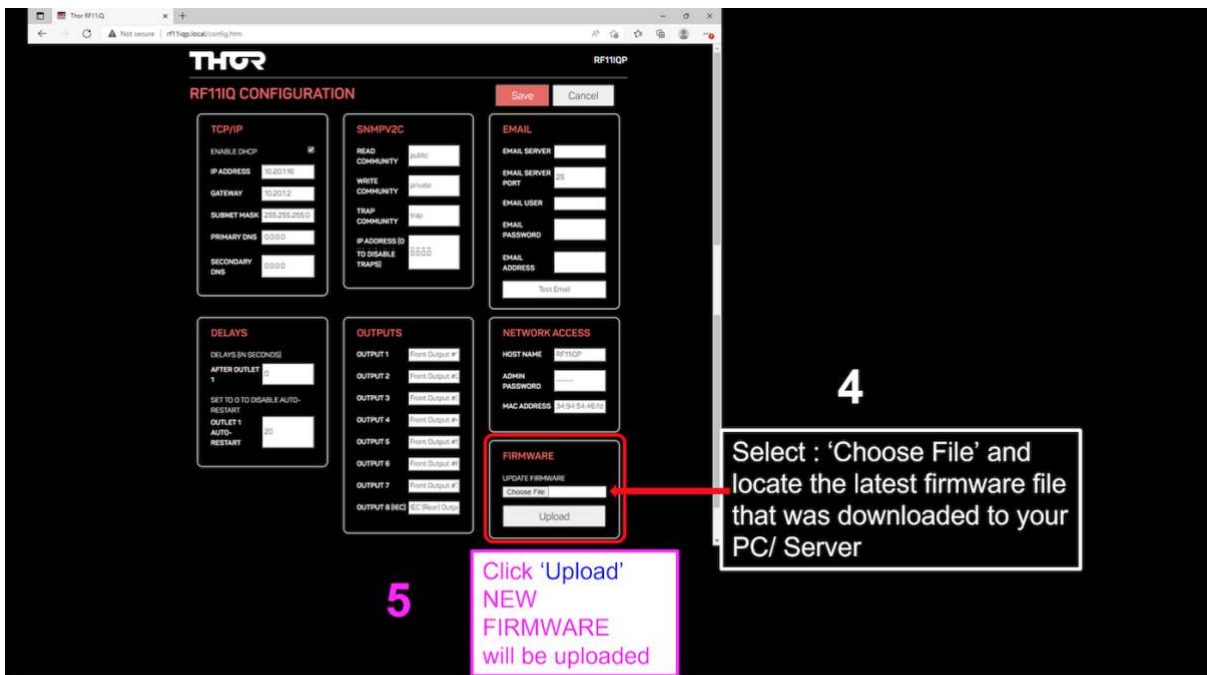

Once New Firmware is uploaded the GUI will disconnect and it is advised that you reconnect as per step 2: '2:CONNECT TO THE RF11IQP USING YOUR BROWSER' and check the GUI shows the updated Firmware as shown in 'Figure 1 GUI RF11IQP'. Do not rely the auto reconnected browser ... ALWAYS RECONNECT

In Firmware section select "Choose File". Go to where the downloaded updated firmware file has been placed in your computer files. (refer section downloaded firmware file from RF11IQP Product page on www.thortechnologies.com.au) download firmware file and upload.

Note: If the firmware update process encounters an error the last known firmware version will be rolled back onto the device.

Check the firmware has been updated on Homepage where firmware version is shown..

The screenshot displays the THOR RF11IQ Dashboard. At the top left is the THOR logo, and at the top right is the model identifier RF11IQP. Below the logo is the title RF11IQ DASHBOARD and a CONFIGURE button. The main area contains eight status cards arranged in a 2x4 grid, each with a circular indicator and a label: 1 MODEM, 2 SWITCH, 3 NAS, 4 BLANK, 5 YAMAHA, 6 BLANK, 7 FRONT OUTPUT #7, and LED. At the bottom left, the IP address 192.168.2.128 is shown with a RESTART button. At the bottom right, a yellow arrow points to the Serial Number (8C4B141F1480), Version (2.15-20220628), and Uptime (14d 02:20:23). A footer contains copyright information for Thor Technologies Pty Ltd and a link for more information.

All done.